

- NOTES:
1. OVERALL HEIGHT IS IN LOADED CONDITION. UNLOADED HEIGHTS MAY BE 4" ABOVE HEIGHTS SHOWN.
 2. DO NOT SCALE DRAWING.
 3. ALL DIMENSIONS ARE APPROXIMATE AND SUBJECT TO ENGINEERING CHANGES.
 4. DRAWING MAY OR MAY NOT SHOW ALL ITEMS AS DESCRIBED IN THE WRITTEN DETAIL SPECIFICATIONS.
 5. INCLUSION OF AN ITEM ON THE DRAWING DOES NOT CONSTITUTE INCLUSION OF THAT ITEM WITH THE FINAL DELIVERED UNIT.
 6. THE EFFECTIVE DOOR OPENINGS WILL BE APPROX. 2" LESS THAN THE NOTED COMPARTMENT OPENING FOR ROLL UP DOORS AND UP TO APPROX. 4" LESS FOR HINGED DOORS

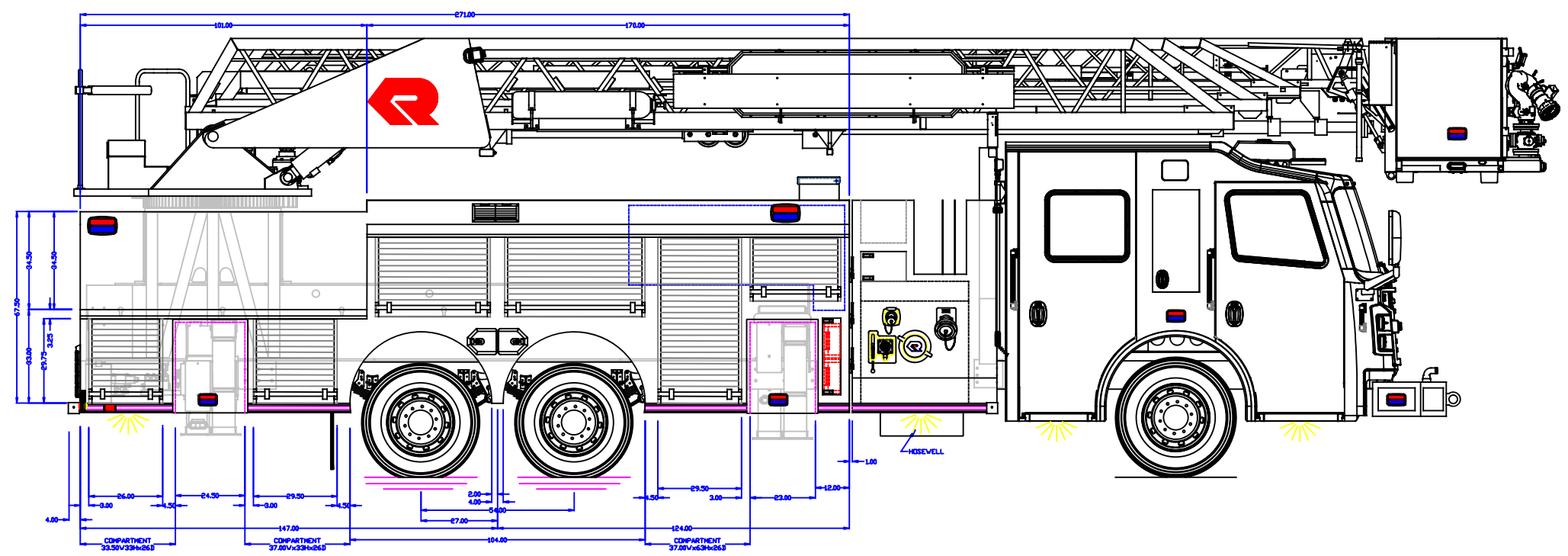
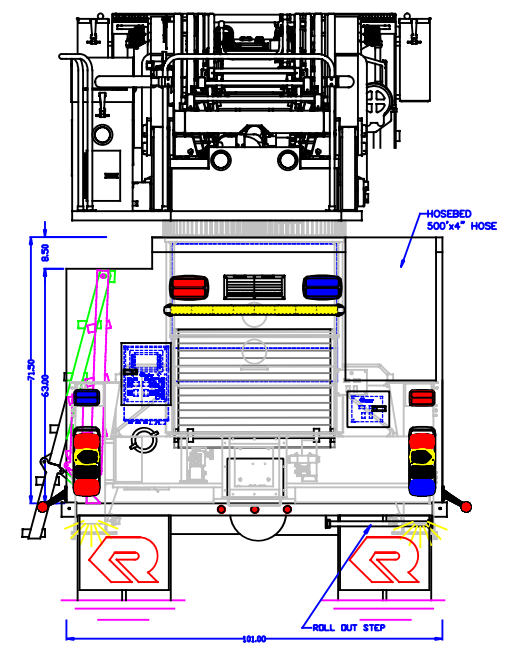
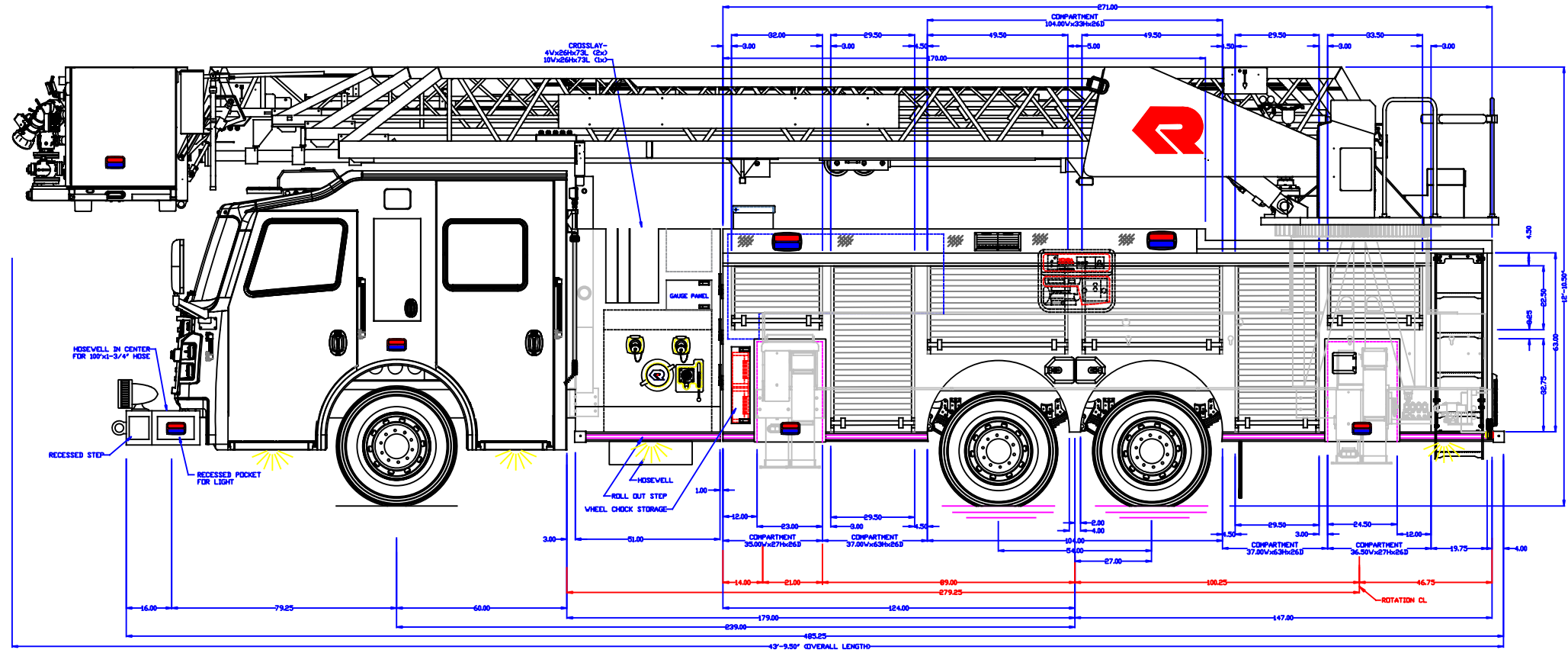
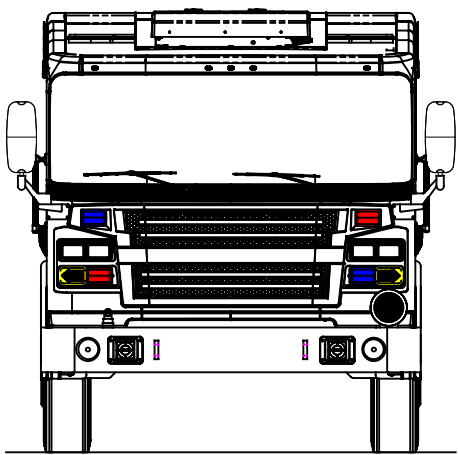
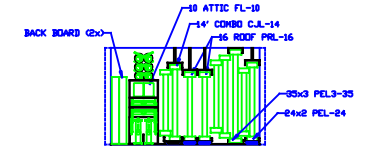
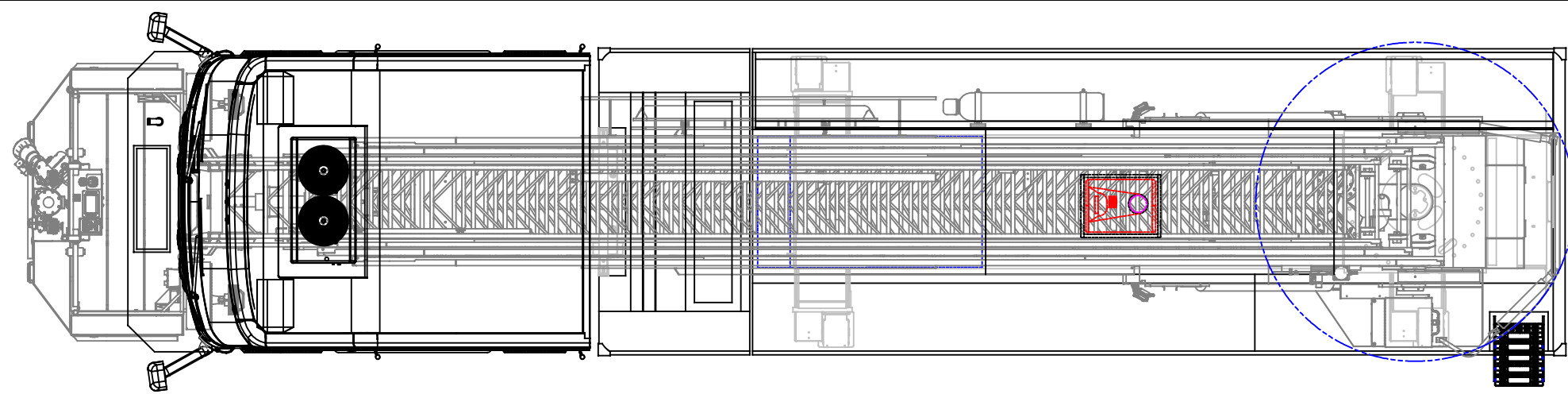

OK FOR PRODUCTION
 INTIALS: KA
 JOB NUMBER: 7516
 DATE: 3/20/2017

MAIN FILE: --
 DEPT: --
 DEALER: --

PRODUCTION APPROVED

APPROVED BY:

CHASSIS:	ROSENBAUER COMMANDER
PUMP:	HALE 1500 GPM
TANK:	POLY/300/40(FOAM)
PANEL MATL:	BLACK THERMO
COMP INTERIOR:	SPATTER COAT
MAXIMUM HEIGHT	NONE
MAXIMUM LENGTH	43' 9.5"
BODY WIDTH	101"

REVISED: SRN	DATE: 3-14-17
REVISED: SRN	DATE: 10-28-16
REVISED: TEK	DATE: 5-17-16
DRAWN: TEK	DATE: 5-5-16

PROPRIETARY AND CONFIDENTIAL
 THE INFORMATION CONTAINED IN THIS DRAWING IS THE SOLE PROPERTY OF ROSENBAUER. ANY REPRODUCTION IN PART OR AS A WHOLE WITHOUT THE WRITTEN PERMISSION OF ROSENBAUER IS PROHIBITED.

CENTRAL ARIZONA, AZ 104 COBRA